

valco
baby

PRODUCT REFERENCE GUIDE

SNAP &
SNAP4
Stroller

© Copyright
VE 2012
vs220113USA

FURTHER INFORMATION:
In North America only
www.valcobaby.com
1800 610 7850

Find us on:



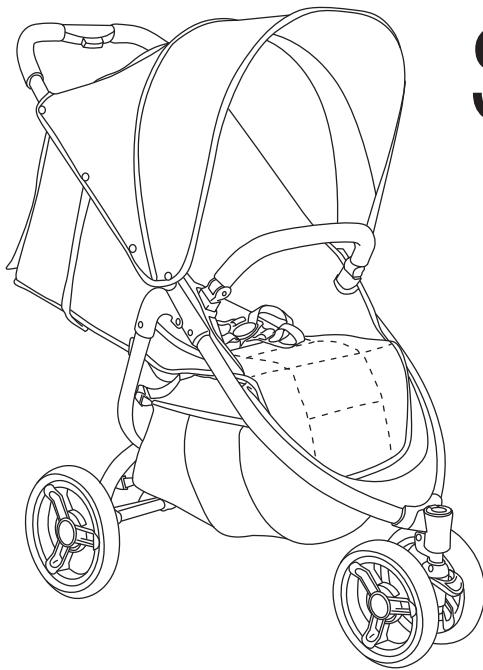

SNAP & SNAP4

Stroller

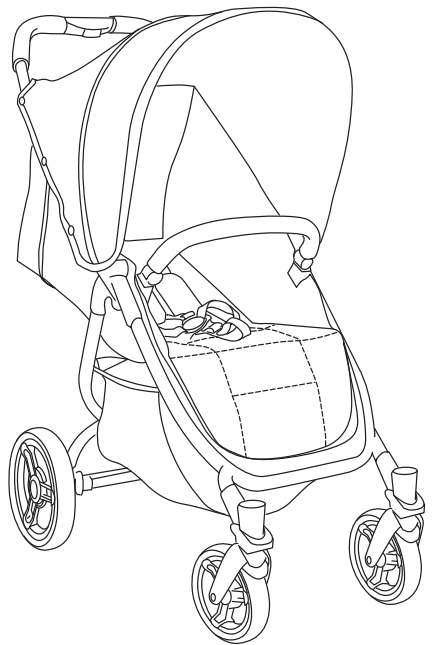

Thank you for purchasing a quality
VALCO BABY product.

Please read and follow the instructions outlined in this guide carefully. Familiarise yourself with the construction and safety features; be sure that you understand all the warnings and safety guidelines before use.



Important: Please read the following instructions carefully before assembling this product. Retain this guide in a safe place for future reference.



DISCLAIMER

Due to our policy of continuous product development, this product is constantly evolving. It is possible that some features or procedures outlined here have changed since this document was written. If you are unsure of any procedure shown here, please contact us via the web at info@valcobaby.com to obtain the most up to date information before use. Include the batch number and model number, which can be found on a sticker on the frame.

All pictures and diagrams herein are provided for illustration purposes only. Actual product, colour or fabric may vary. VALCO BABY reserves the right to modify or alter any specification or colour without notice or obligation to modify any product previously purchased

1>PARTS LIST



BUMPER
BAR

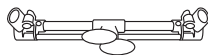

REAR AXLE

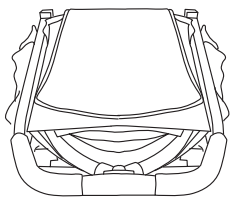

STROLLER FRAME,
SEAT & HOOD UNIT

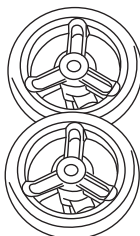

REAR WHEELS x 2

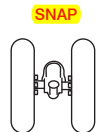

SNAP

1x FRONT DUAL
WHEEL



1x FRONT
WHEEL SHAFT

SNAP 4

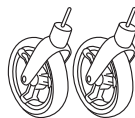

2x FRONT
WHEELS

2>TO OPEN

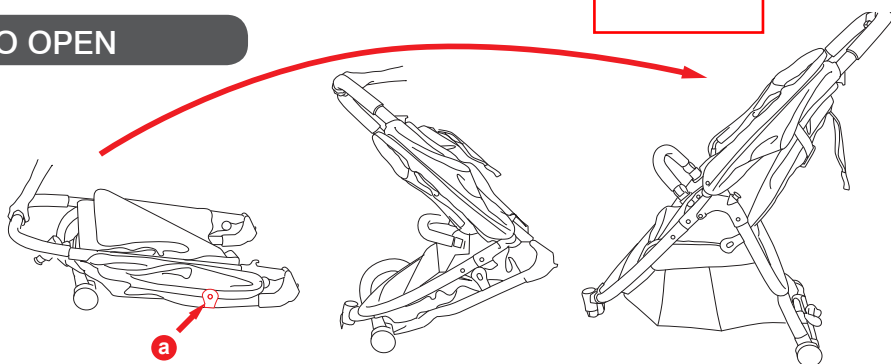

3>REAR AXLE

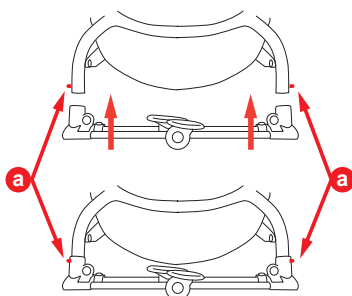

4>REAR WHEELS & BRAKE

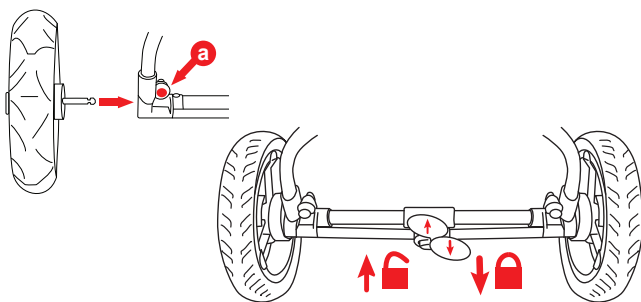

5>FRONT WHEELS

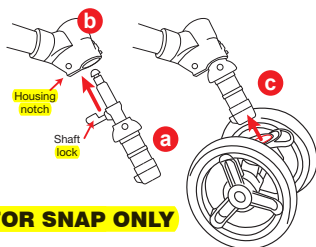

FOR SNAP ONLY

FOR SNAP AND
SNAP 4

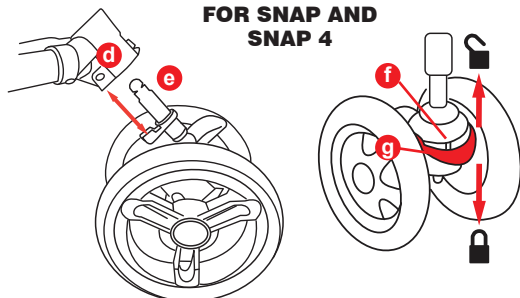

6>TO FOLD

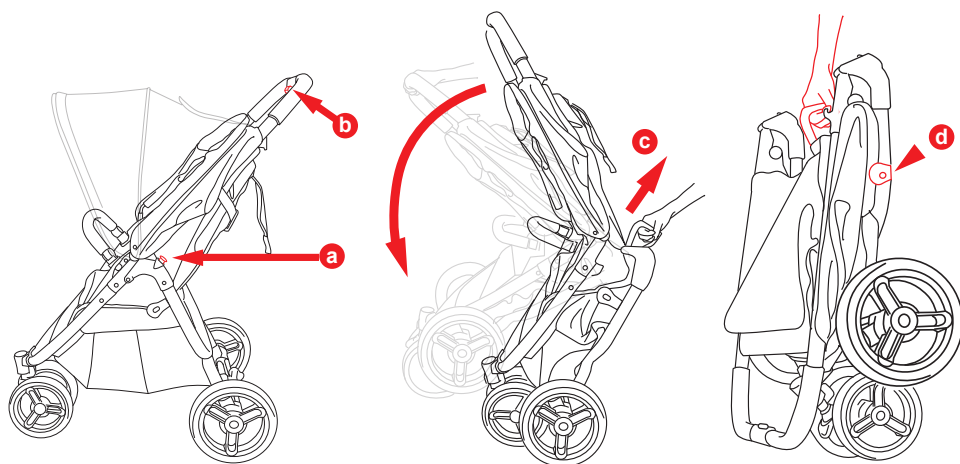

7>BUMPER BAR

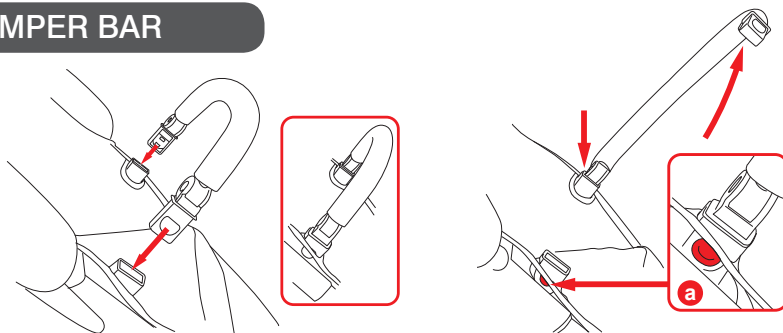

8>SEAT RECLINE

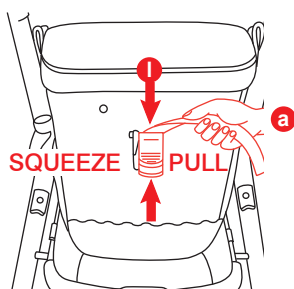

9> HARNESS

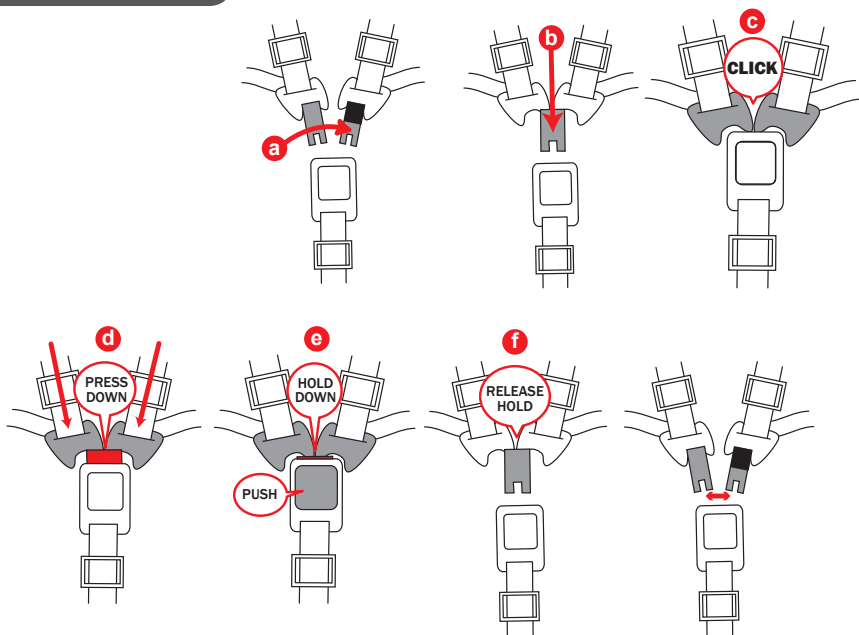

10> HOOD

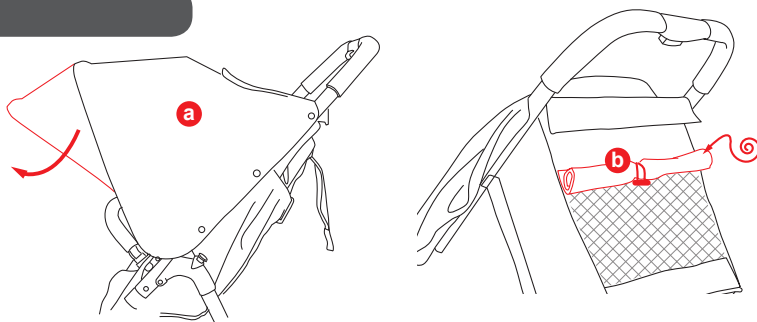

11> TETHER STRAP

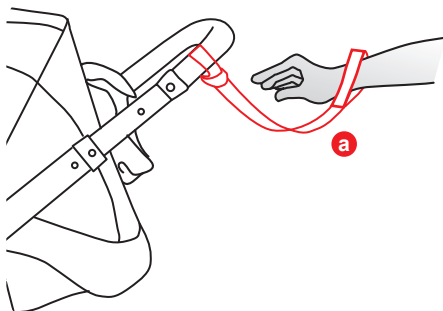

INSTRUCTIONS

1>PARTS LIST

Stroller frame with hood attached, 2x rear wheels, 1x front dual swivel wheel & front wheel shaft (Snap) or 2x front swivel wheels with shaft attached (Snap 4), 1x bumper bar.

2>TO OPEN

Release the frame lock (a) by pulling it clear of the locking pin.

Lift the handle in one continuous motion while allowing the legs to simultaneously open. Continue until the frame locks fully open.

⚠️IMPORTANT WARNING: ALWAYS TEST THAT ALL LATCHES ARE SECURELY ENGAGED BEFORE USE.

3>REAR BRAKE AXLE

Align the rear axle housing with the rear stroller legs. Insert each rear leg into the corresponding housing of the rear axle. Press in the locking button (a) on the leg while simultaneously pushing the axle housing as far as it will go until it engages. Repeat for the other leg.

Test that each leg has fully engaged in the axle housing.

4>REAR WHEELS & BRAKE

While depressing the button (a) at the rear axle junction, insert the rear wheel axle into the rear axle tube of the stroller. Push the axle into the tube as far as it will go before releasing the button.

Repeat for other wheel.

To release your wheel, press button (b) and pull from axle tube.

IMPORTANT: TEST THAT EACH WHEEL HAS FULLY ENGAGED IN THE FRAME TUBE BEFORE USE BY PULLING ON IT.

To use the rear brakes:

Press down on the right side of the red brake lever located on the rear axle to simultaneously engage the brake in both rear wheels.

To release, press down on the left side of the red brake lever with your foot.

⚠️IMPORTANT WARNING: ALWAYS TEST THAT THE BRAKES ARE SECURELY DISENGAGED BEFORE USE.

5>FRONT WHEELS

FOR SNAP ONLY:

Install the front wheel shaft to the stroller first: align the front wheel shaft (a) with the front wheel housing (b) taking care to orientate the shaft lock with the notch found on the rear of the wheel housing. Insert the front wheel shaft into the housing until it is engaged.

Align the front wheel with the shaft and slip the wheel onto the shaft. Note that the locking tab should be positioned to the front. Insert the wheel over the shaft until it is engaged.

FOR SNAP AND SNAP4: Align each front wheel pin (a) beneath the housing (b) on each front leg of the stroller. Be sure that the pin engages securely in the channel

IMPORTANT: ALWAYS TEST THAT ALL LATCHES ARE SECURELY ENGAGED AND THE WHEEL HAS SECURELY ENGAGED IN THE CHANNEL BEFORE USE.

To fix the front wheel(s) in the non-swivel position: Turn the wheel so that the notch at the front of the wheel channel (c) lines up with the one in the top plastic housing (d).

Press down firmly on the tab until it locks into place.

6>TO FOLD

Press down on the secondary lock button (a) - it will stay down. Squeeze the fold button in the handle (b), moving the handle forward slightly.

Grasp the folding handle (c) allowing the handle to move all the way forward till the frame automatically locks shut (d).

Your SNAP stroller can stand unaided for easy storage.

HINT: WHILE NOT NECESSARY FOR FOLDING, MOVING THE SEAT BACK FIRST TO THE MOST UPRIGHT POSITION AND FORWARD THROUGH THE FRAME WILL MAKE FOR THE MOST SIMPLE AND COMPACT FOLDING.

Note: Your Snap stroller also comes equipped with a handy shoulder strap for easy carrying.

7>BUMPER BAR

Insert each side of the bumper bar fitting into the corresponding housing in the seat frame until you hear it click into place.

The bumper bar can be opened as a “gate” for easy access pressing on one of the release buttons (a) and lifting the side out of the housing. For full removal, repeat this process for the other side.

8>SEAT RECLINE

To recline: While squeezing the seat adjuster tabs (a) together in a pincer like movement, ease the seat down to the desired position. Release the tabs and the seat will automatically lock in that position

To incline: Place your hand in the centre of the seat at the rear. Pull the incline strap (b) while gently pushing the seat upward to the desired position.

9>HARNES

To secure your child in the harness:

Overlap buckles and so that they fit together to form one complete buckle (a).

Insert the completed buckle into the Buckle Housing (b) until it engages securely in place(c).

To open your harness:

Push down on both Buckle Prongs (d).

Simultaneously press the release button in the centre of the buckle (e).

Lift the buckles from the Buckle Housing (f).

IMPORTANT WARNING:

AVOID SERIOUS INJURY FROM FALLING OR SLIDING OUT. ALWAYS USE SEAT BELT.

10>EXPANDA HOOD

Your SNAP hood is designed to provide maximum shade and comfort for your child by incorporating our EXPANDA HOOD section.

To increase/decrease the hood size

Open the EXPANDA HOOD section fully using the zip (a).

Gently pull your hood forward; extending it as far as is required.

When no longer needed, fold the EXPANDA HOOD backward, allowing it to fold in on itself.

Gently zip the section closed being mindful not to catch any of the fabric in the zipper teeth.

Additional ventilation can be achieved by rolling up the rear of the hood like a blind and securing in the open position with the toggle (b).

11>TETHER STRAP

Your SNAP stroller is fitted with a handy tether strap which helps keep your stroller always within reach. Slip the tether cuff (a) over your wrist and use the stroller normally.

IMPORTANT: ALWAYS USE THE TETHER STRAP WHEN A CHILD IS IN THE STROLLER

WARNING: TO AVOID INJURY OR DEATH

- ALWAYS APPLY THE BRAKES WHENEVER THE PRAM/STROLLER IS STATIONARY
- DO NOT LEAVE CHILDREN UNATTENDED.
- DO NOT CARRY EXTRA CHILDREN OR BAGS ON THIS PRAM/STROLLER.
- MAKE SURE CHILDREN ARE CLEAR OF ANY MOVING PARTS IF YOU ADJUST THE PRAM/STROLLER. OTHERWISE THEY MAY BE INJURED.

 **WARNING: USE THIS HARNESS AT ALL TIMES.**

 **WARNING: WHEN NOT IN USE DISCONNECT SHOULDER STRAPS FROM THE WAIST STRAP AND/OR BUCKLE.**

- FOLLOW THE MANUFACTURER'S INSTRUCTIONS.

Remember, your child's safety is your responsibility...

- NEVER USE ON STAIRS OR ESCALATORS.
- ALWAYS USE THE TETHER STRAP WHEN THE STROLLER IS IN USE.
- THE CORRECT USE AND MAINTENANCE OF THIS VEHICLE ARE ESSENTIAL.
- BE SURE THAT ALL CLAMPS AND BUCKLES ARE SECURELY FIXED AND IN PLACE BEFORE USE
-  ALWAYS USE THE HARNESS, CORRECTLY FITTED AND ADJUSTED, WITH YOUR CHILD IN THIS SEAT.
- THE MAXIMUM WEIGHT OF THE CHILD FOR WHICH THIS STROLLER WAS INTENDED IS 20KGS (44LBS)..
- THE MAXIMUM HEIGHT OF THE CHILD FOR WHICH THIS STROLLER WAS INTENDED IS 90CM (35INCHES).
- THE STROLLER WILL BECOME UNSTABLE IF THE MANUFACTURER'S RECOMMENDED LOAD IS EXCEEDED.
- CARE MUST BE TAKEN WHEN FOLDING AND UNFOLDING THE PRODUCT TO PREVENT FINGER ENTRAPMENT.
- CAN BE USED FROM A NEWBORN BABY ONWARDS. A COCOON, SPECIALLY DESIGNED TO BE USED WITH A STROLLER, IS RECOMMENDED WHEN ANY FULLY RECLINING STROLLER IS USED WITH A NEWBORN.
- NEVER RUN WITH A NEWBORN BABY IN ANY PRAM OR STROLLER UNTIL THE CHILD CAN SIT UP UNASSISTED (APPROXIMATELY 6 MONTHS).
- CHECK ALL PARTS BEFORE USE FOR BREAKAGE OR FATIGUE. DISCONTINUE USE IMMEDIATELY IF ANY PART IS FOUND TO BE DAMAGED OR BROKEN.
- MAXIMUM LOAD OF BASKETS: 5KGS (11LBS).
- DO NOT CARRY ADDITIONAL CHILDREN.

THIS STROLLER IS MANUFACTURED FOR USE WITH ONE CHILD ONLY

- ALWAYS BE AWARE OF THE RISKS PROVIDED BY FIRE AND OTHER SIGNIFICANT SOURCES OF HEAT SUCH AS RADIATORS, ETC. WHICH MAY BE IN THE IMMEDIATE VICINITY OF YOUR STROLLER.
- IT MAY BE UNSAFE TO USE ANY ACCESSORIES OTHER THAN VALCO BABY APPROVED ONES.
- THIS PRODUCT IS INTENDED FOR DOMESTIC USE ONLY. IT IS NOT INTENDED FOR COMMERCIAL USE.

Should the chassis become wet, dry off promptly before storing. If this pram is used near the ocean or salted roads, spray the chassis and seat frame with water and dry. We recommend a rust inhibiting product should be used to prevent rust and fatigue on metal parts.

We recommend that you wipe down axles and lubricate the wheels every 3 months. Sand and dirt can grind down axles, if you live near the beach or in a dusty environment you must wipe down the axles and wheels then lubricate them monthly.

AXLES ARE BEST LUBRICATED WITH GREASE OR PETROLEUM JELLY. MOVING PARTS ARE BEST LUBRICATED WITH SILICONE BASED PRODUCTS. DO NOT USE OIL BASED PRODUCTS.

FURTHER INFORMATION:
In North America only
www.valcobaby.com

1800 610 7850
info@valcobaby.com
Find us on:



valco
baby